

GOT PELLETS BAGS?

CUT THEM OPEN BEFORE RECYCLING!

Why cut the bags open?

If there is any pellet content or sawdust remaining in the bag (it gets stuck in the corners), recyclers may reject it as contaminated plastic. Make your recycling efforts COUNT!

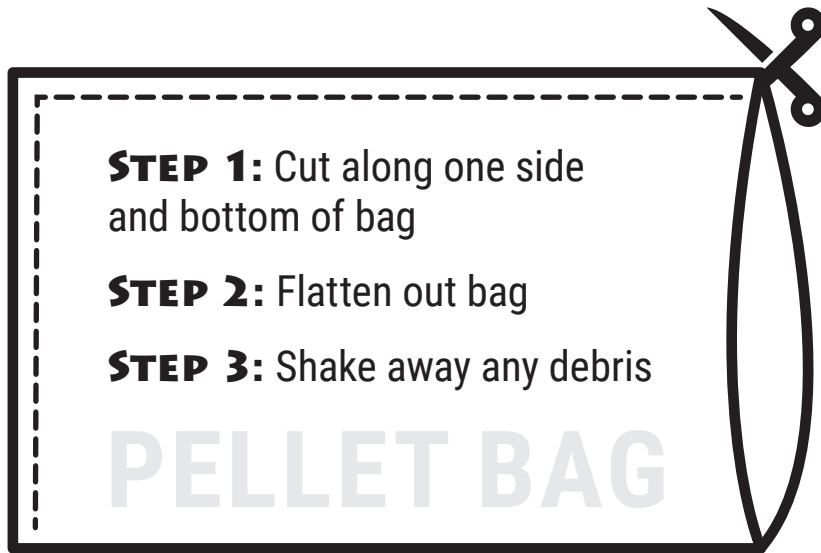
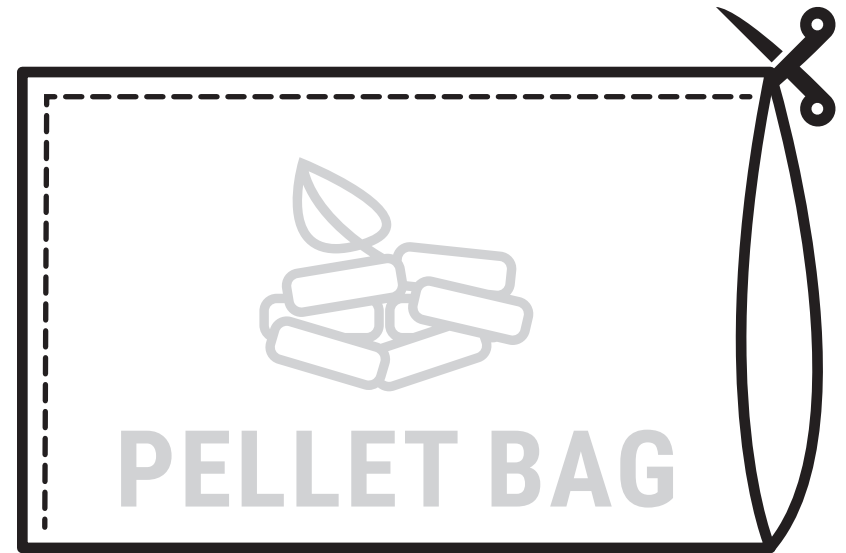

STEP 1: Cut along one side
and bottom of bag

STEP 2: Flatten out bag

STEP 3: Shake away any debris

PELLET BAG



**CENTRAL VERMONT SOLID WASTE
MANAGEMENT DISTRICT**

CVSWMD.ORG • 802-229-9383