

**Minutes of the Meeting of the CVSWMD Board and Executive Board of Supervisors
Central Vermont Chamber of Commerce – 33 Stewart Rd. Berlin**

November 4, 2015

A meeting of the CVSWMD Board of Supervisors – Towns represented and Board of Supervisors/Alternates present were:

Representative	Town	4/15	5/15	9/15	11/15
Micheli, S.	Barre City	X	X		X
Taft, R. (alt)	Barre City				
Thumm, F.	Barre Town	X	X		
Mitchell, J. (alt)	Barre Town			X	X
Levin, M.	Berlin	X	X	X	X
Postpischil, G.	Bradford	X	X	X	X
Powell, B.	Calais	X		X	X
Lembke, M.	Chelsea	X	X		X
Callan, G.	E. Montpelier	X		X	
Hanson, B.	Fairlee				
Kellogg, N.	Hardwick	X	X	X	X
Krauth, A.	Middlesex	X	X		
Wheeler, C.	Montpelier				X
Bate, D. (alt)	Montpelier		X		
Cattaneo, L.	Orange	X	X	X	X
Zeisel, L.	Plainfield	X	X	X	X
Vacant	Tunbridge				
Gershun, D.	Walden				
Carbee, P	Washington		X	X	
Sandlin, C.	Williamstown	X	X	X	
Vacant	Woodbury				

Others in attendance:

Leesa Stewart, Cathleen Gent, Cassandra Hemenway, Chrissy Bellmyer, Barb Baird
David Declore – Times Argus

Lee Cattaneo called the meeting to order at 6:35 (1)

Agenda Revisions (2)

None

Public Comment Period and Announcements (3)

Mia Moore came to say goodbye to the board and introduced Claire Wheeler, the new representative for Montpelier. Moore shared that she expressed to the Montpelier City Council that CVSWMMD was set up to implement Act 148 before it even came along. She also shared with the City Council how impressed she has been with the District staff.

Lee Cattaneo welcomed Claire. Round the table introductions.

Applause for Mia Moore and all her work the past 7 years with the CVSWMMD.

Committee and Executive Board reports (4)

Matt Levin wondered about a tire discussion. Will the Executive Board be taking it up? Can we make time for it at another meeting?

Consent Agenda (5)

- Adopt the minutes of the September 2015 Board meeting
- Accept the minutes of the Executive Board and Committee meetings

Bill Powell moved the Consent Agenda. The motion was seconded and passed unanimously.

Approve Grant to Rumney School (6)

Matt Levin went over the grant in the packet. **Mark Lembke moved to award Rumney School \$1,999.78. The motion was seconded and passed unanimously.**

School Program Update (7)

Chrissy Bellmyer, School Program Manager, gave a presentation to the board on the school programs the district offers.

E-waste Plan (8)

Leesa Stewart explained that the EPR legislation was successful for 3 years. Recently a letter from the collection entity went out stating that there would no longer be payment for participants in the program. The State and collection entity are in talks. While Stewart had wanted direction from the board on the issue, after talking to the POC right before this meeting, she will take the next 3 weeks to delve more deeply into the subject and report to the Executive Board. The full board will take it up at another meeting.

Facility Planning (9)

Cathleen Gent gave a presentation to the board on the history of facility discussions within the board, survey results, focus group meetings and facility possibilities. (attached)

Agenda items # 10 and 11 postponed to a later meeting.

Leesa Stewart explained that things are changing as some Districts are applying for variance. There were questions regarding what the CVSWMMD *has* to include in a facility per Act 148. Discussion followed with no action taken.

Approve Fee Schedule (10)

Postponed

Set the Per Capita for Fiscal Year 2017 (11)

Postponed

Round Table and Announcements (12)

Lee Cattaneo – someone take a picture of the cookies and send it to Charles

Mark Lembke – tires were dumped on my land and then some of them were taken

Nancy Kellogg – we should collaborate with haulers

Barb Baird – welcome Claire

Leesa Stewart – welcome Claire

Cathleen Gent – reminded folks that the December board meeting will start and 5 and include supper

Gerhard Postpischil – shredded tires used on playgrounds and fields causes a rise in cancer rates/found a mistake in the facility designs

Claire Wheeler – thanked everyone and said there is a lot to learn

Motion to adjourn at 8:30 p.m.

Prepared by: 



Facility Planning Discussion
CVSWMMD Board of Supervisors Meeting
November 4, 2015

Cathleen Gent
Planning Analyst

How Did CVSWMD Get Here?

- 2012 Board Retreat – Posed the question: should CVSWMD own a facility?
- 2013 Board Retreat – Discussed location and design elements
- 2014 Board Retreat and December 2014 meeting – Directed staff to start developing business plan and options (using Option 3).

OPTION 3 – All Three Categories

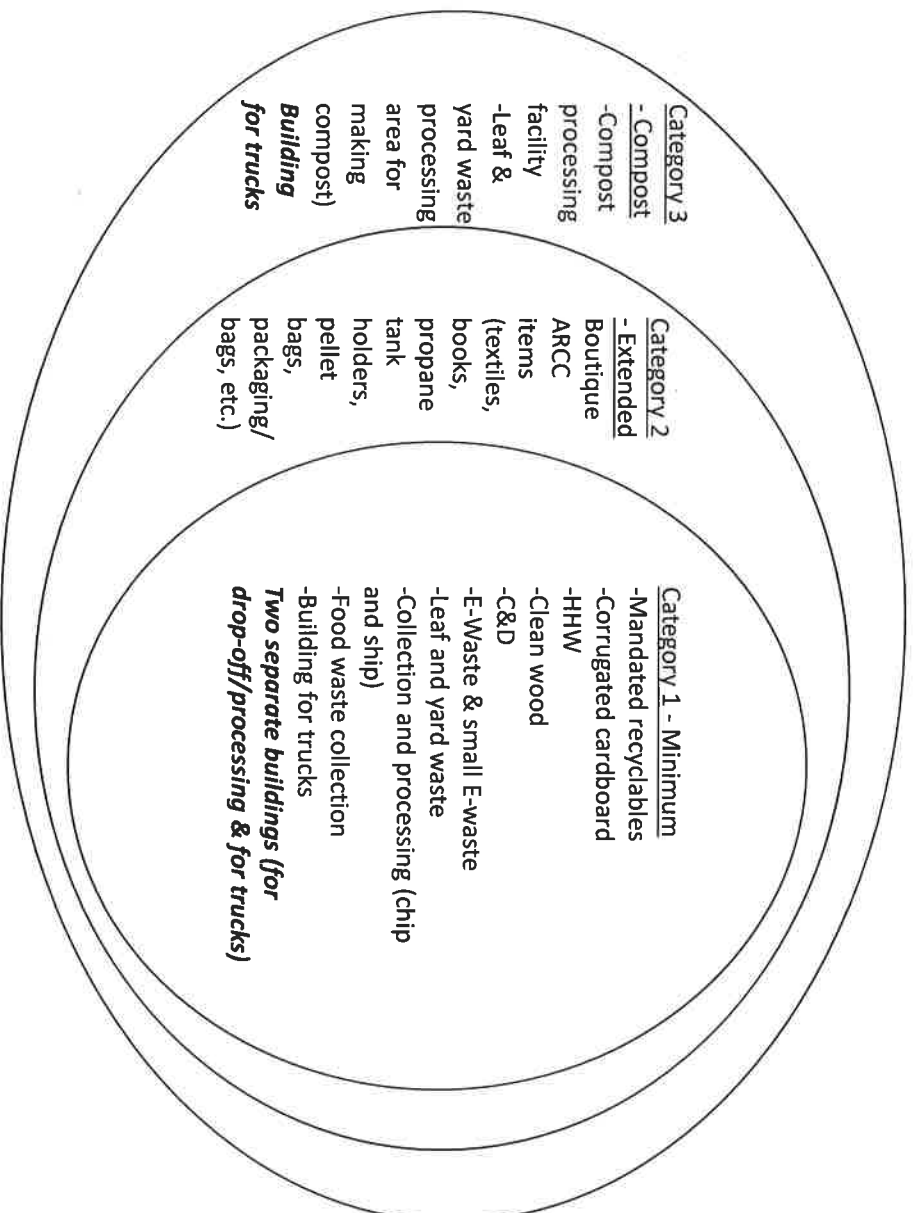

How Did CVSWMD Get Here?

- Issued RFPs and Hired Firms:
 - Materials and Market Analysis (NRRA)
 - Architectural and Engineering Study (Gossens Bachman Associates)
 - Focus Group Facilitation (Barry Lawson Associates)
- Issued RFQ for Development Proposals:
 - Received proposal for compost facility (SCS Engineers – Suffern, NY)
- Other Activities:
 - September 2015 – BOS Accepted Facility Outreach Plan
 - September 2015 – Investigate property on Route 14S in East Montpelier
 - October 2015 – Social Media Survey – over 400 respondents
 - October 2015 – Three Focus Discussion Groups (Hardwick, Montpelier, Chelsea)
 - November 2015 – Hauler Survey to be conducted
 - Fall 2015 – Preparing Facility Business Plan – Present during December BOS meeting

What Have We Learned?

Materials and Market Analysis

- Total predicted revenue for recycling materials – Act 148 Improvement Between \$368,000 and \$552,000 (primarily through mandated recyclables)
 - Not pursuing collection of mandated recyclables/MRF – potential collection of individual materials
- To achieve predicted tonnage and revenues → one stop shop, fees, need certain volumes, look at flow control, build a large flexible facility with sufficient space
- Current system in central Vermont – existing private waste resource firms, transportation costs
- Source separation of materials
- Encourage CVSWMD to reconsider compost facility

What Have We Learned?

Materials and Market Analysis

- Hub and Spoke Model – for rural areas
- Facility must generate revenues to offset costs
- Minimum building footprint = 10,000 s.f.
 - Building expansion potential
- Ideal building footprint = 20,000 to 22,000 s.f.
- Components:
 - Truck scale, baler, sufficient storage space
 - Traffic flow with source separation of materials, then specialty waste (and swap shop), then MSW
- If possible, find existing structure to retrofit or add on over time

What Have We Learned?

Architectural and Engineering Study - GBA

- Acreage – minimum of 7.25 acres (5.25 developed)/compost facility separate
- Total building square footage – approximately 26,000 s.f.
- Campus schema – with nine separate buildings/structures, leaf and yard area, traffic flow, parking, gate, perimeter fence
- Setbacks and buffers, site coverage limitations – about 2 acres
- Facility Total Building Construction – Between \$3.8 and \$4.1 million
- Preliminary Construction Budget – Between \$4.7 and \$5.1 million
(includes permitting and some professional fees, but not site work and landscaping)

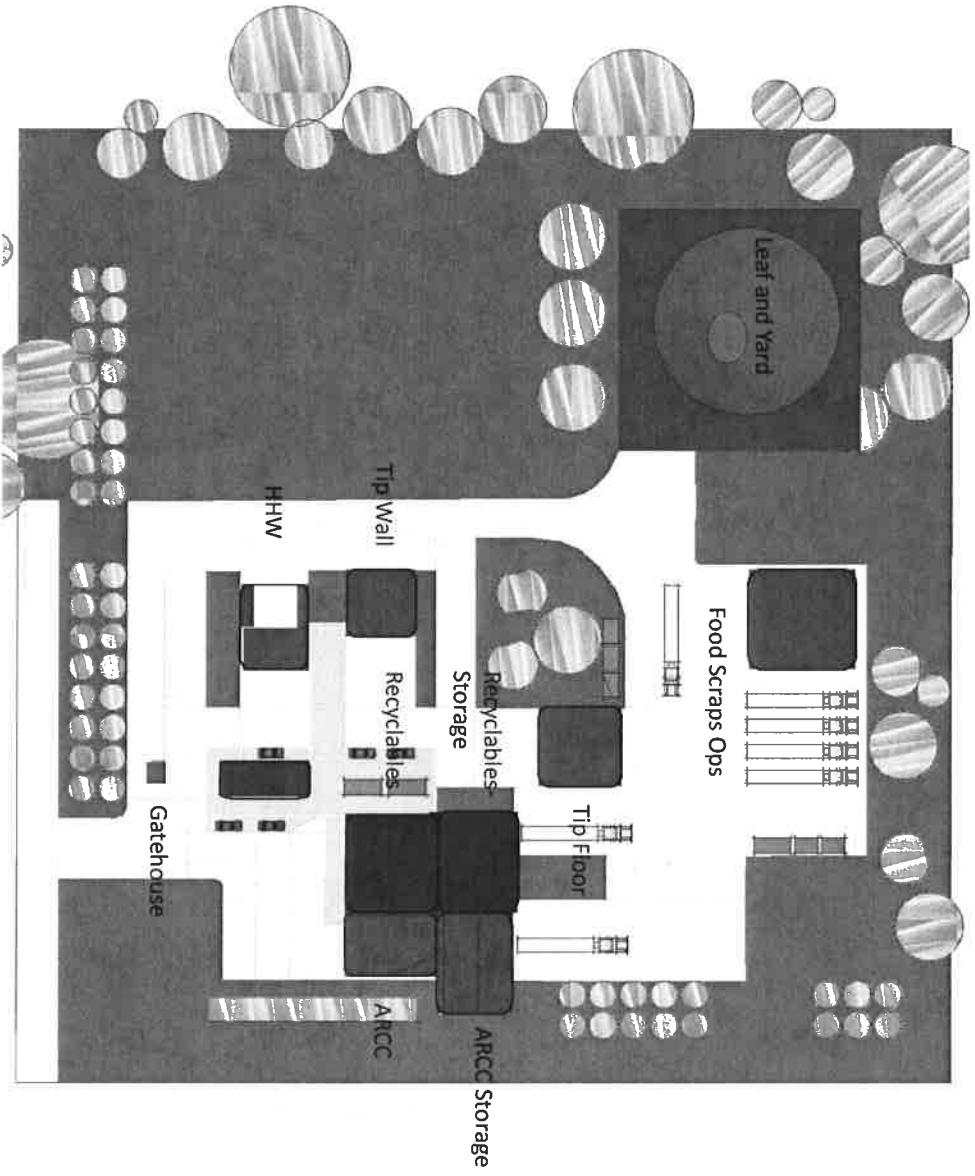

What Have We Learned? Social Media Survey

Number of Respondents = 434/

Number of In-District Respondents = 416

- Commitment to recycling/reuse = over 90% - very supportive/supportive
- Impressions of community efforts = 83% - slow but steady/great progress
- Zero Waste Goal = Excellent and worth pursuing/good goal – 85%

Q5 What recycling or reuse materials would you bring to a facility in central Vermont? [Please check all that apply]

Answered: 37 | Skipped: 0

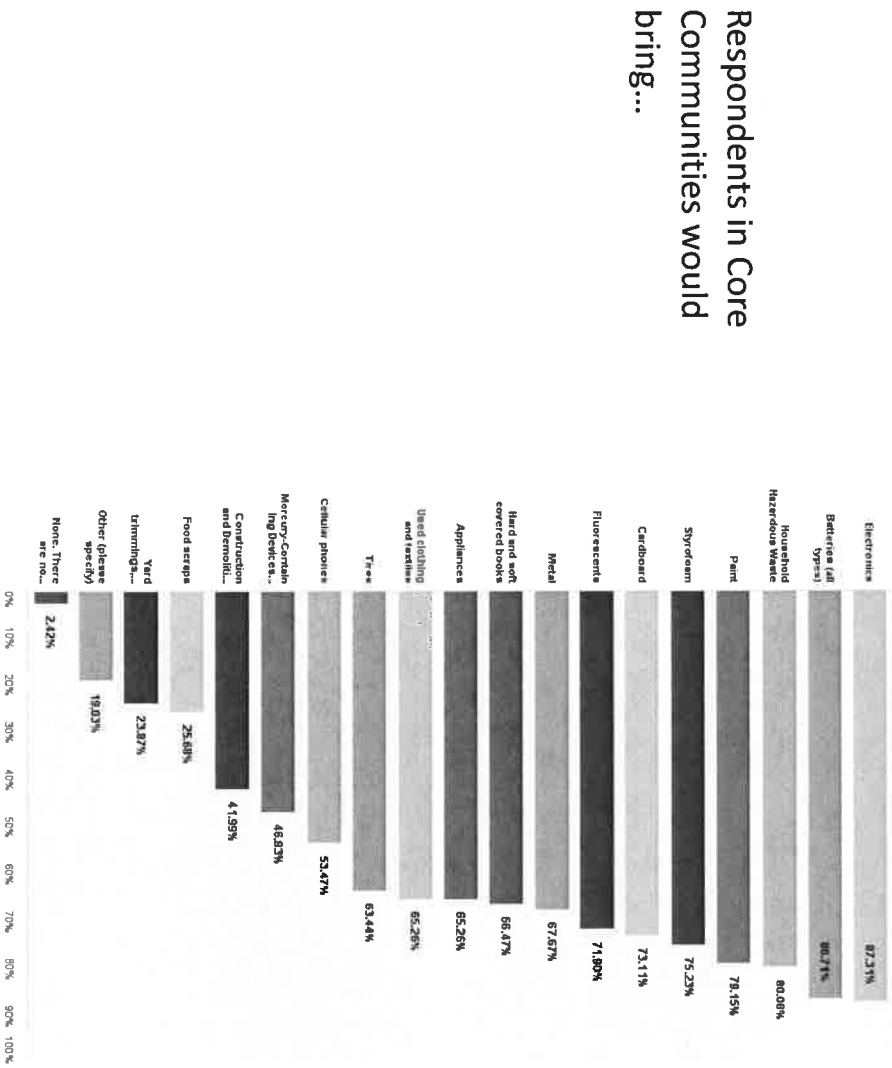

RESPONDENTS WHO LIVE IN "RURAL" AREA OF DISTRICT... Would drive to regional facility for ...

CR CYSWMD is looking to site a facility that would provide a "hub and spoke" model to rural towns, using existing local facilities as well as a regional drop off center. Local facilities may not be able to take many of the materials that a regional facility could take. Given that information, which materials would you be willing to drive to a facility in the Barre/Montpelier area? [Check all that apply.]

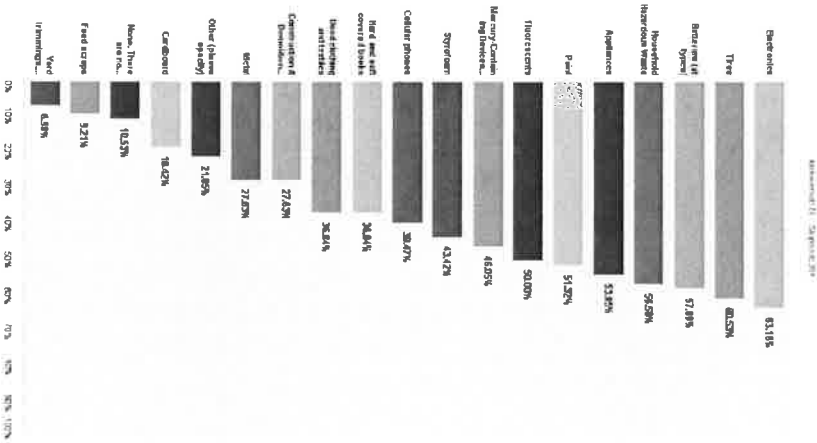

**RESPONDENTS WHO LIVE IN
"RURAL" AREA OF DISTRICT...
Would NOT drive to regional
facility for ...**

Q7 Which recycling or reuse materials would you only drop off at your local transfer station or collection site? In other words, you would not bring the materials to a regional recycling center. [Check all that apply.]

Answered: 71 54/11/16 14:1

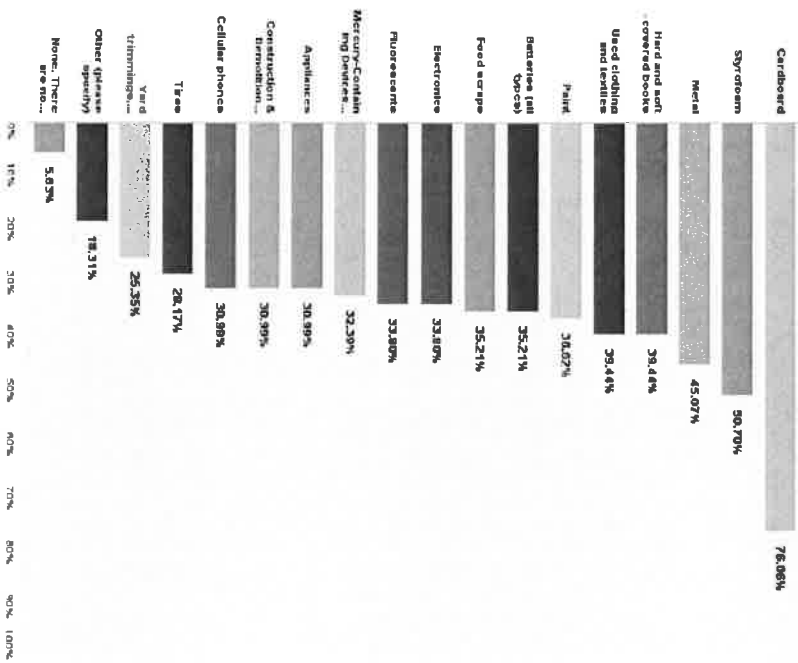

What Have We Learned?

Social Media Survey

Q8 How important are the factors that affect your use of CVS/WMD's facility? [Please check an answer for each item.]

Answered: 404 Skipped: 31

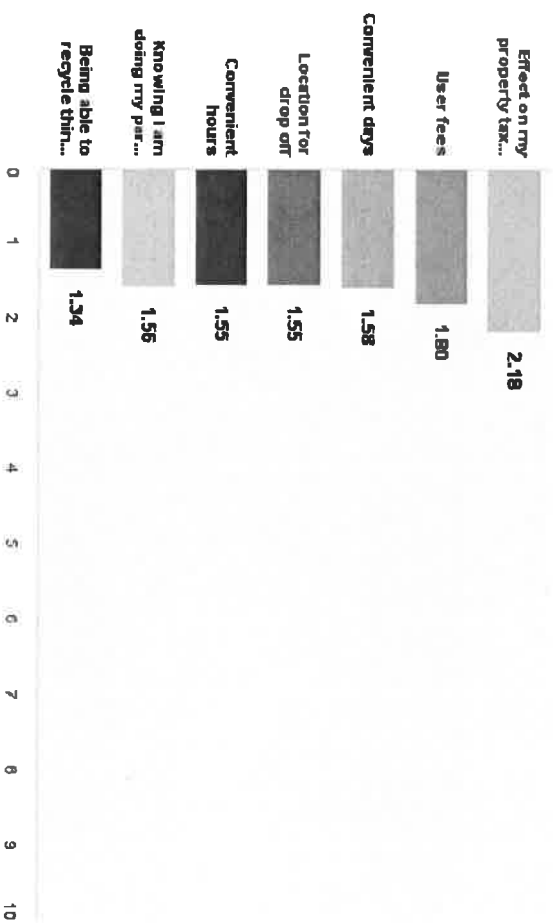

What Have We Learned? Social Media Survey

Q9 How do you prefer to fund the services provided by the District? [Check all that apply.]

Answered: 392 Skipped: 13

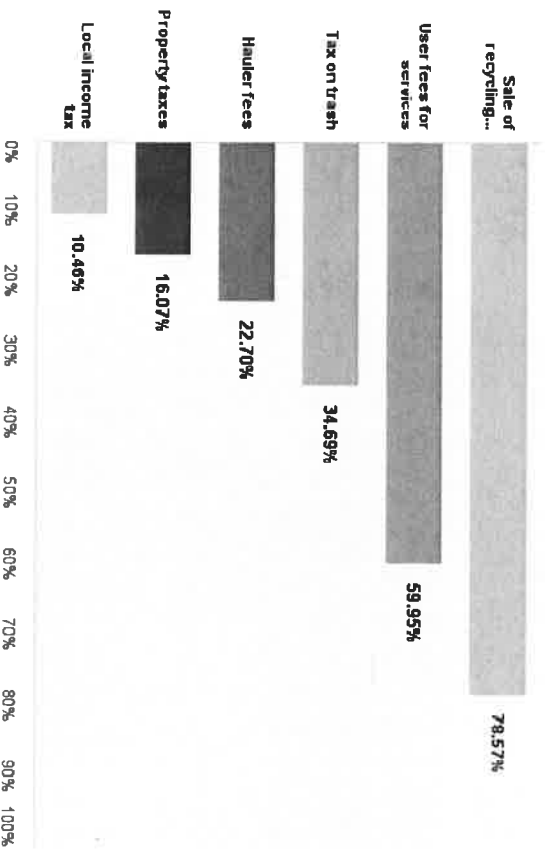

What Have We Learned?

Focus Discussion Groups

- All towns represented at 3 meetings (Hardwick, Montpelier, Chelsea)
 - 34 Participants
- Work with children. Be in the schools. Children inspire recycling at home.
- Not convinced the ARCC is the biggest bang for the buck.
- People want one-stop shopping.
 - Like the hub and spoke approach
 - ROVER truck is seen as the best option -- park at local transfer stations
- People do not want to drive to a central facility.

What Have We Learned?

Focus Discussion Groups

- Recycling leaves and yard waste not as important in rural towns, although some understand that Barre City may need something.
- People love the HHW/PBB collections
 - Want more in their local areas.
- Estimated cost of facility and impact on property taxes are major concerns.
- No one would support the scale of what is reflected in the GBA report.
- There is not opposition to the concept of a facility (especially to house the organics program and current operations)
 - Concern about the size and cost.
 - Concern about NIMBY.
- Some participants said that Casella and Myers (haulers) meet their needs and they do not see any need for any facility.

What Have We Learned? Hauler Survey

- Survey will be conducted over next month
- Survey Goals:
 - Act 148 - To assess what is going well and challenges being faced for current and future implementations
 - Potential Partnerships – Act 148 requirements and CVSWMD facility

Facility Business Plan

- General Manager has analyzed bond scenarios
 - \$1 million bond → ~\$2.00 per capita in FY17 and ~\$2.35 per capita in FY18-FY22
 - Average increase for a \$200K home with per capita increases from \$1 → \$2.17 through \$4.64
- Revenues Projection
 - Using likely revenues from NRRRA study, revenues from materials to cover operations, not bond
 - Look for grants or no-interest loans
- Facility Staff Working Group – Based on GBA cost estimates and bond scenarios, is working on a scaled back facility
 - Reduce services, products, number of buildings
 - Purchase enough land so that we can expand over time
 - Integrate hub and spoke model
 - Plan is to present the Facility Business Plan in December at extended BOS meeting

Board Guidance

1. What are the programming priorities? Ways to cut back size/scope?
 - Look at the 3 Options scenario from last December – POC and BOS
 - Future of the ARCC – EB (November) and BOS (December)
2. If private haulers or other companies offer services (excluding EPR programs) that CVSWMD might offer in facility, should we compete with those firms?
3. Should CVSWMD pursue a Green Facility as a priority?
4. Politically, is there an appetite for higher per capita amount and/or surcharge? If so, any guidance about those amounts?